

# SERVICE MANUAL



## STEREO TURNTABLE

**TP 240**  
(EUROPE)



### SPECIFICATIONS

Motor	DC servo motor	Cartridge and stylus	Magnetic stereo cartridge
Drive system	Belt drive		(VM type) (No. MG-44J) and
Speed	33-1/3 and 45 rpm		0.6 mil diamond stylus
Wow and flutter	0.05% (WRMS)		(No. ST-44J)
Rumble	-70 dB	Stylus pressure	1.25 g
Turntable platter	304 mm (12")	Frequency response	20 - 20,000 Hz
Tone arm	Static-balance straight type	Channel separation	20 dB
Tracking error	±1.5°	Power source	AC 220 V, 50 Hz
Overhang	15 mm	Power consumption	2 W
		Dimensions (Approx.)	420(W) x 350(D) x 115(H) mm
		Weight (Approx.)	3.4 kg

## ADJUSTMENT

### ADJUSTMENT OF HEADSHELL

The headshell attached to the tonearm should not be inclined either to the right or to the left. If necessary, loosen the two screws on the bottom of the tubular arm and adjust the headshell. Be sure that the stylus is normal to the record surface.

**NOTE:** Do not take out these screws.

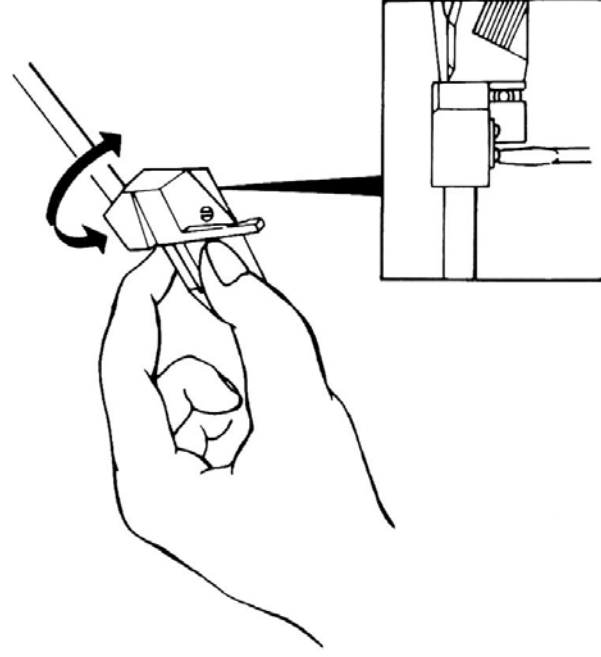

### ADJUSTMENT OF AUTO-RETURN

Remove the turntable, and place the tonearm in the reset position (1). In this state, move the main gear M5 so that the end of lever M7 may be seated in the recess of cam of main gear M5. Push lower trip lever M6 and trip lever M16 in the direction of arrow A and arrow B, respectively.

Insert a screwdriver into the hole for "auto return adjust" and turn it right or left until the end of trip lever M16 starts to hit against the lower trip lever M6 (arrow C) when the distance between the center shaft of turntable and stylus becomes 64 to 65 mm by moving the tonearm.

Put on the turntable, and check the auto-return performance.

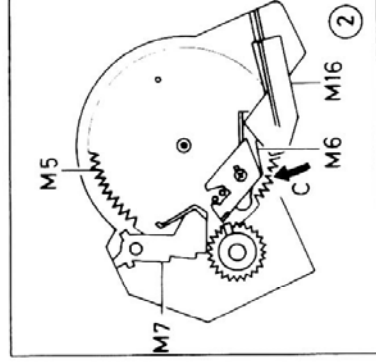
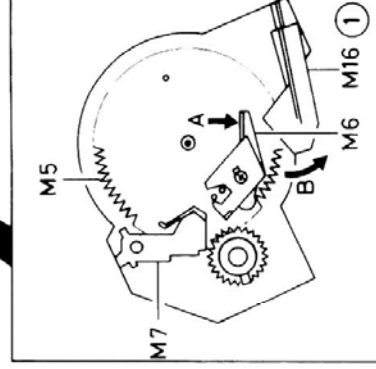
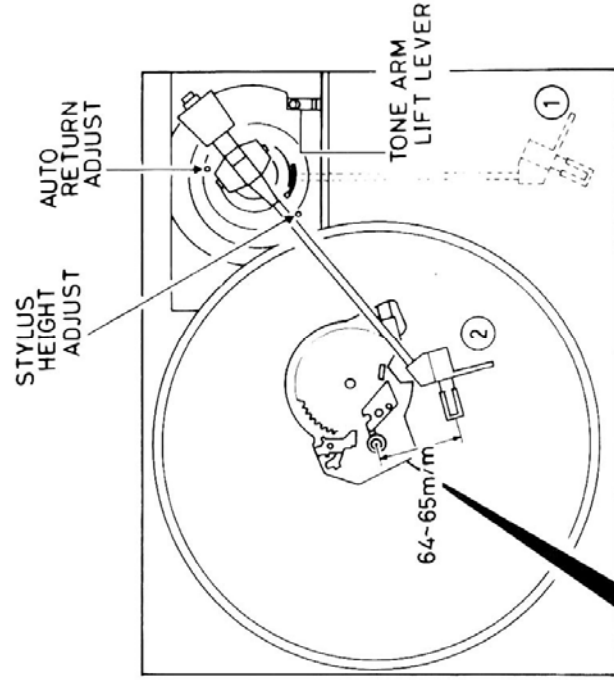

ARM EXPLODED VIEW

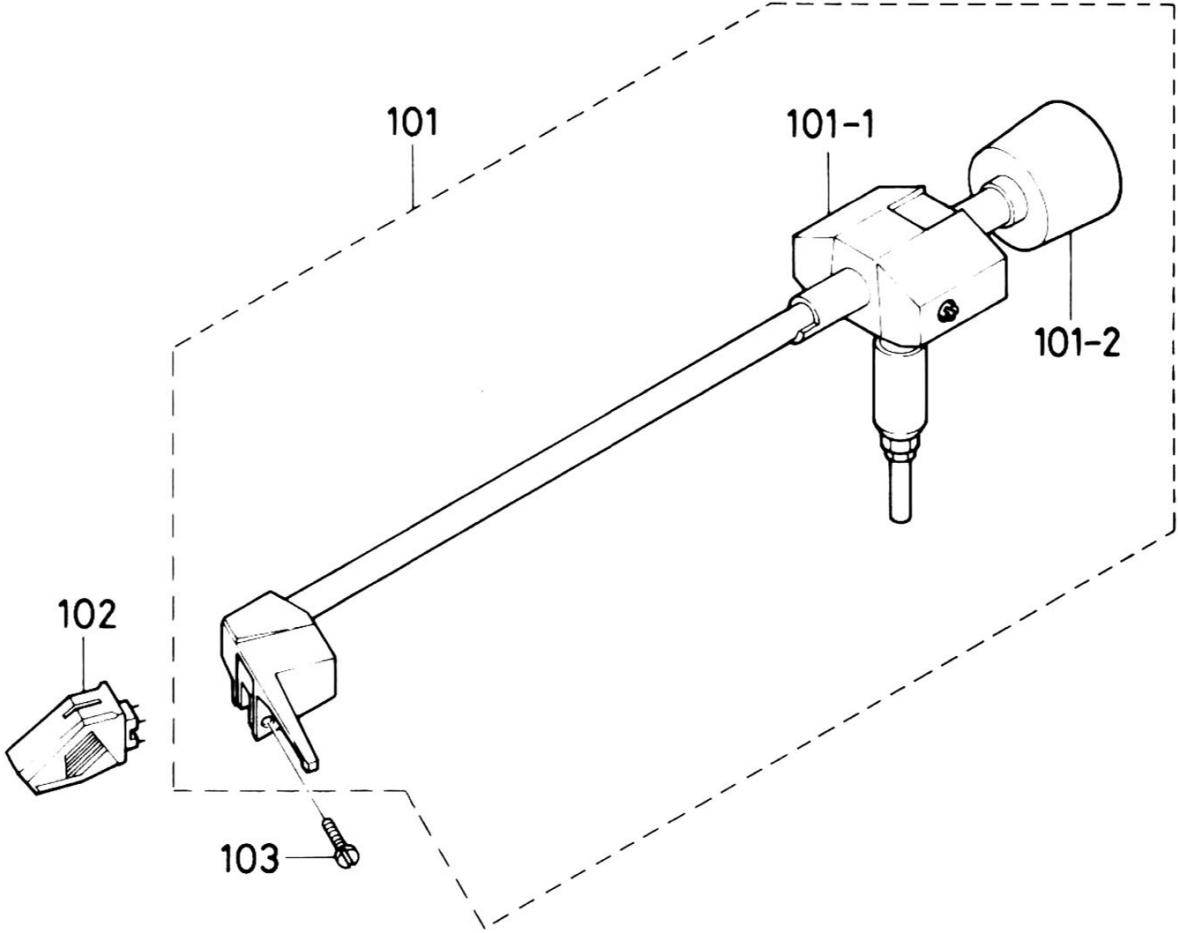

# SCHEMATIC DIAGRAM

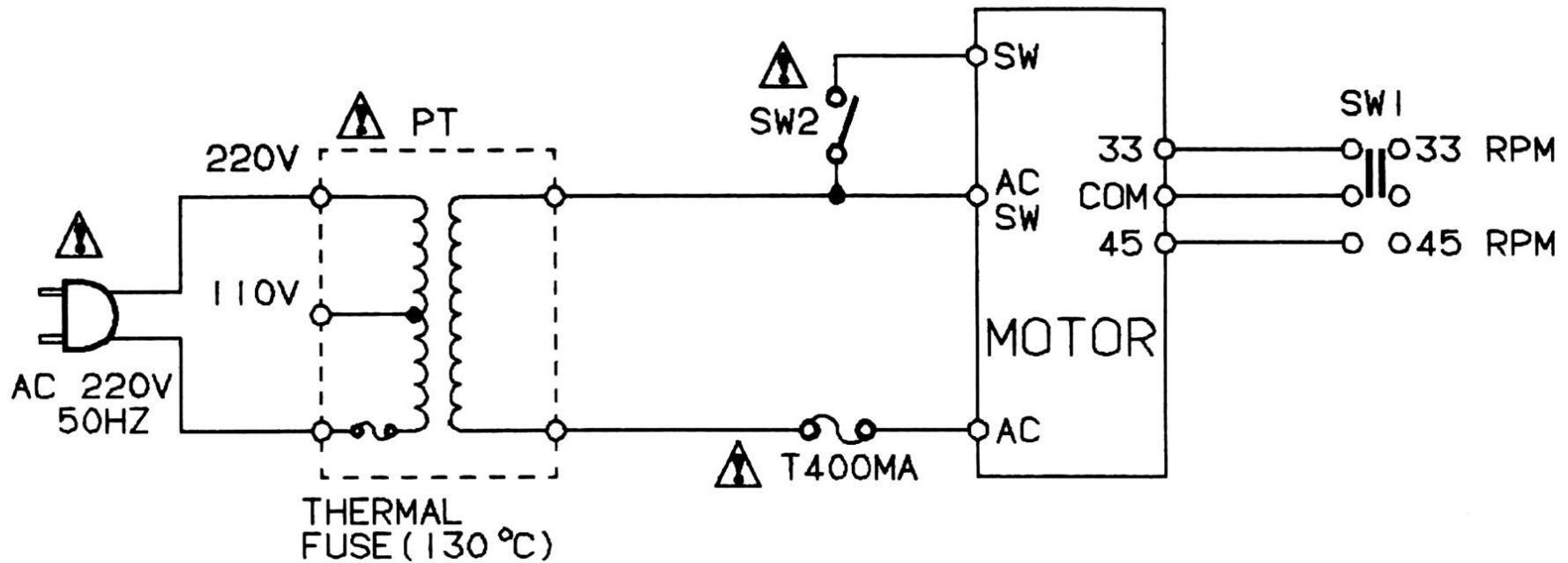

All parts bearing the  symbol were manufactured to conform to special safety standards. When replacing, do not use parts numbers other than those specified.

## ADJUSTMENT

### ADJUSTMENT OF MICROSWITCH

Determine the position with screw Y20 so that the end of arm lever M26 may coincide with the notch of the rib in the bottom of deck panel when the tonearm is set in the reset position (see expanded view).

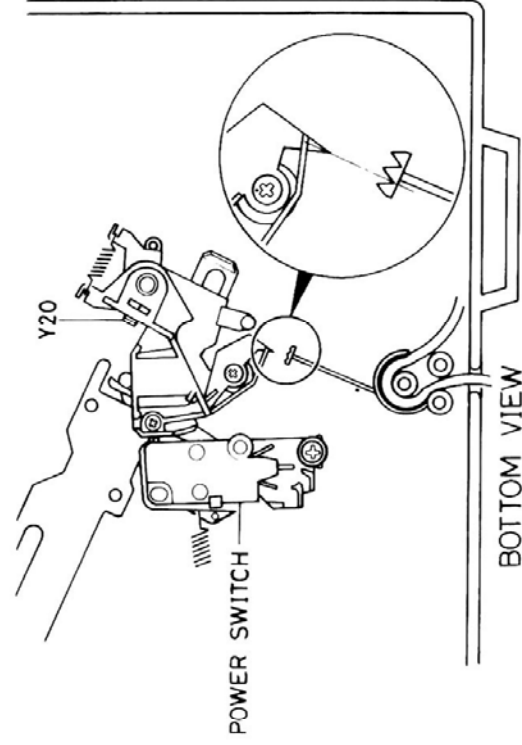

### ADJUSTMENT OF STYLUS HEIGHT

Setting the record disk in place, raise the tonearm lift lever.

Bring the tonearm to above the disk, and insert a screwdriver into the "stylus height adjust" hole (see drawing for ADJUSTMENT OF AUTO-RETURN) and turn it right or left until the distance between the disk and stylus becomes  $8 \pm 1$  mm.

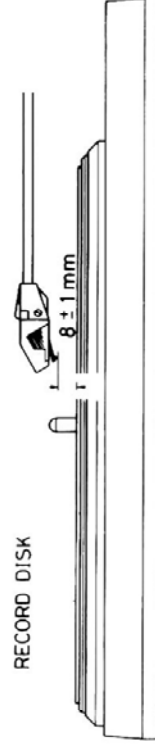

### ADJUSTMENT OF TUNTABLE SPEED

Play a wow flutter checking record, and adjust by turning SVR1 (33 rpm) and SVR2 (45 rpm) so as to obtain the specified frequency.

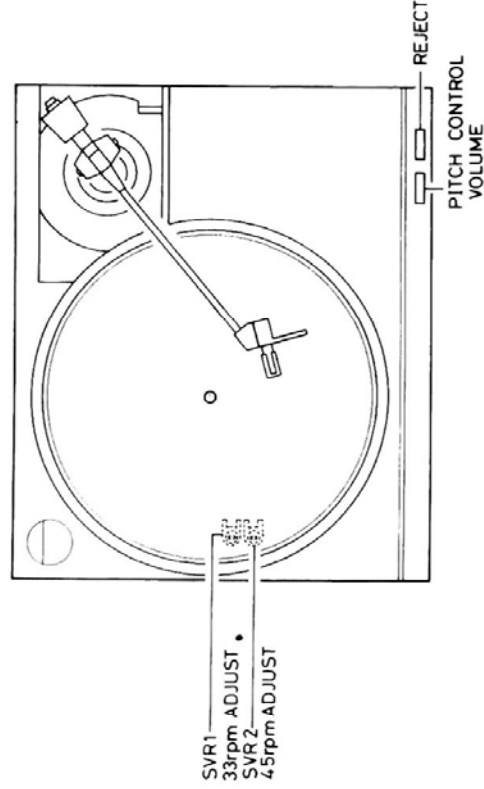

MECHANISM EXPLODED VIEW

